

## CONJUNTO PEDALIN ACOMPAÑANTE

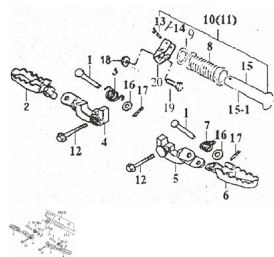

Rating: Not Rated Yet

**Price:**

Variant price modifier:

Base price with tax:

Price with discount:

Salesprice with discount:

Sales price:

Sales price without tax:

Discount:

Tax amount:

[Ask a question about this product](#)

Description

|   | Ref. | Título  |            | Código |
|---|------|---|------------|--------|
| 1 |      | PIVOTE 8*40                                     | 18-GB/T882 |        |
| 2 |      | PEDALIN DELANTERO IZQUIERDO ZTT 200             | 18-42540   |        |
| 3 |      | RESORTE TRASERO,REPOSAPIES<br>DELANTERO-DERECHO | 18-42511   |        |
| 4 |      | SOPORTE DELANTERA DEL REPOSAPIES,IZQUIERDO      | 18-42530   |        |

## ESTRUCTURA : CONJUNTO PEDALIN ACOMPAÑANTE

---

| Ref. | Título   | Código        |
|------|--|---------------|
| 5    | SOPORTE DELANTERA DEL REPOSAPIES,DERECHO           | 18-42630      |
| 6    | PEDALIN DELANTERO DERECHO ZTT 200                  | 18-42640      |
| 7    | RESORTE TRASERO,REPOSAPIES DELANTEROZ<br>IZQUIERDO | 18-42611      |
| 8    | GOMA PEDALIN ACOMPAÑANTE ZTT 200                   | 18-42852      |
| 9    | ARANDELA,BARRA POSTERIOR DEL REPOSAPIES            | 18-42853      |
| 10   | PEDALIN ACOMPAÑANTE ZTT 200                        | 18-42770      |
| 12   | TORNILLO M8*50                                     | 18-GB/T5789   |
| 13   | PIVOTE 8*40  | 18-GB/T882    |
| 14   | PERNO 2*20   | 18-GB/T91     |
| 15   | BARRA POSTERIOR DEL REPOSAPIES,IZQUIERDA           | 18-42790      |
| 16   | ARANDELA 8   | 18-GB/T848    |
| 17   | PERNO 2*20   | 18-GB/T91     |
| 18   | TUERCA M10*1.25                                    | 18-GB/T6177.2 |
| 19   | TORNILLO M6*20                                     | 18-GB/T16674  |
| 20   | SOPORTE PEDALIN ACOMPAÑANTE ZTT 200                | 18-42740      |

