

GRUPO EMBRAGUE DE ARRANQUE

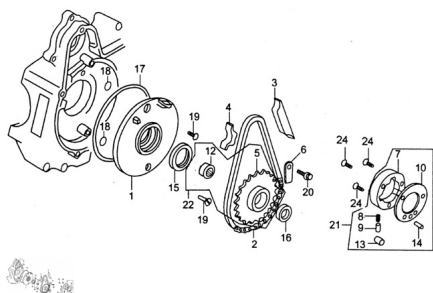

Rating: Not Rated Yet

Price:

Variant price modifier:

Base price with tax:

Price with discount:

Salesprice with discount:

Sales price: 1,00 \$

Sales price without tax: 1,00 \$

Discount:

Tax amount:

[Ask a question about this product](#)

Description

| Ref. | Título | Código |
|------|----------------------------------|-----------|
| 1. | TAPA CENTRAL | 172-0A060 |
| 2. | CADENA DE ARRANQUE | 172-0I011 |
| 3. | TENSOR CADENA DE ARRANQUE | 172-0C006 |
| 4. | GUIA IMPULSOR CADENA DE ARRANQUE | 172-0C007 |
| 5. | ENGRANAJE DE ARRANQUE | 172-0I020 |
| 6. | LAMINA LOCALIZADORA DE ARRANQUE | 172-0L027 |
| 7. | CUERPO EMBRAGUE DE ARRANQUE | 172-0G072 |
| 8. | RESORTE | 172-0G073 |
| 9. | ALOJAMIENTO RESORTE | 172-0G074 |
| 10. | COBERTOR EMBRAGUE DE ARRANQUE | 172-0G075 |
| 11. | RODAMIENTO AGUJA | 172-0I021 |
| 12. | RODILLO 10X10 | 172-0G071 |
| 13. | PERNO 5X12 | 172-0G076 |
| 14. | RETEN 30X42X4.5 | 172-0C019 |
| 15. | RETEN 18.9X30X5 | 172-0C028 |
| 16. | O-RING 107X2 | 172-01C06 |
| 17. | O-RING 6.8X1.9 | 172-0C048 |

MOTOR : GRUPO EMBRAGUE DE ARRANQUE

| | Ref. | Título | | Código |
|-----|------|--------------------------------|--|-------------|
| 18. | | TORNILLO M6X16 | | 172-90601 |
| 19. | | TORNILLO M6 X 28 | | 172-83060 |
| 20. | | EMBRAGUE DE ARRANQUE | | 172-1-10-21 |
| 21. | | CONJUNTO ENGRANAJE DE ARRANQUE | | 172-1-10-22 |
| 22. | | TORNILLO M6X14 | | 172-06014 |