

## GRUPO VALVULAS

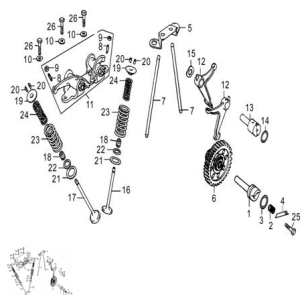

Rating: Not Rated Yet

**Price:**

Variant price modifier:

Base price with tax:

Price with discount:

Salesprice with discount:

Sales price:

Sales price without tax:

Discount:

Tax amount:

[Ask a question about this product](#)

| Description | Ref. | Título                                 | Código   |
|-------------|------|--|----------|
|             | 1    | EJE ENGR<br>ANAJE<br>ARBOL DE<br>LEVAS | 7-14132  |
|             | 2    | RESORTE<br>ARBOL DE<br>LEVA            | 7-14134  |
|             | 3    | O-RING 20<br>X 2.5                     | 7-14136  |
|             | 4    | TAPON<br>ARBOL DE<br>LEVAS             | 7-14137  |
|             | 5    | SOPORTE<br>BARRA DE<br>EMPUJE          | 18-14261 |
|             | 6    |  | 7-14220  |
|             | 7    | VARILLA I                              | 18-14250 |

| Ref. | Título                      | Código    |
|------|-----------------------------|-----------|
| 8    | TORNILLO                    | 18-14415  |
| 9    | TUERCA A JUSTABLE VALVULA   | 18-14416  |
| 10   |                             | 18-14425  |
| 11   | C. BALANCIN DE VALVULA      | 18-14440  |
| 12   | LEVA INFERIOR               | 18-14451  |
| 13   | EJE INFERIOR ARBOL DE LEVAS | 18-14452  |
| 14   | O-RING 17X2.5               | 18-14453  |
| 15   |                             | 18-14454  |
| 16   | VALVULA DE ADMISION         | 18-147100 |
| 17   | VALVULA DE ESCAPE           | 18-14720  |
| 18   | RETEN DE VALVULA            | 18-14730  |
| 19   | RESORTE                     | 18-14751  |
| 20   |                             | 18-14752  |
| 21   | RESORTE EXTERIOR            | 18-14753  |
| 22   | RESORTE INTERIOR            | 18-14754  |
| 23   | RESORTE VALVULA EXTERIOR    | 18-14755  |
| 24   | RESORTE VALVULA INTERIOR    | 18-14756  |
| 25   | TORNILLO M6X12              |           |
| 26   | TORNILLO M8X30              |           |

