

PARRILLAS DE SUSPENSION DELANTERA

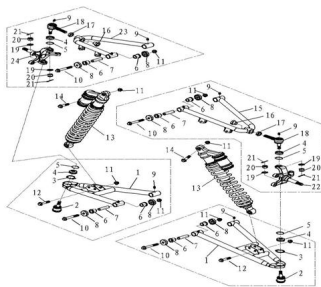

Rating: Not Rated Yet

Price:

Variant price modifier:

Base price with tax:

Price with discount:

Salesprice with discount:

Sales price:

Sales price without tax:

Discount:

Tax amount:

[Ask a question about this product](#)

| Description | Ref. | Título | Código |
|-------------|------|----------------------------|--------|
| | 1 | Balancin superior | |
| | 2 | rotula suspension inferior | |
| | 3 | seguro circular externo | 132-30 |
| | 4 | protector de goma | |
| | 5 | aro de acero | |
| | 6 | tapon brazo | |

ESTRUCTURA : PARRILLAS DE SUSPENSION DELANTERA

| Ref. | Título | Código |
|------|--|------------|
| | | suspension |
| 7 | tubo revestidor inerior suspension | |
| 8 | tapa protectora suspension | |
| 9 | niple engrasador | |
| 10 | tornillo M10 *P1.25*78 | |
| 11 | arandela grower | 132-10 |
| 12 | tornillo M10 *P1.25*50 | |
| 13 | | |
| 14 | tornillo M10 *P1.25*45 | |
| 15 | suspension delantera superior izquierda | |
| 16 | tuerca junta de rotula M14 | |
| 17 | tuerca hexagonal M16 | 132-16 |
| 18 | junta de rotula superior | |
| 19 | tuerca hexagonal M 12 derecha | 132-12 |
| 20 | tuerca hexagonal M 12 derecha | 132-12 |
| 21 | pasador | |
| 22 | rotula o nudillo de direccion izquierdo | |
| 23 | suspension superior delantera derecha | |

| Ref. | Título | Código |
|------|--------|---|
| | 24 | rotula o nudillo de dirección izquierdo |