

## SUSPENSION DELANTERA

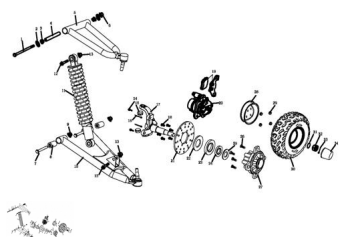

Rating: Not Rated Yet

**Price:**

Variant price modifier:

Base price with tax:

Price with discount:

Salesprice with discount:

Sales price:

Sales price without tax:

Discount:

Tax amount:

[Ask a question about this product](#)

| Description | Ref. | Título               | Código   |
|-------------|------|----------------------|----------|
|             | 1    | TORNILLO<br>M10x195  | 47-80035 |
|             | 2    | TAPON                | 47-80450 |
|             | 3    | BUJE<br>SOLIDO       | 47-80385 |
|             | 4    |                      |          |
|             | 5    | PARRILLA<br>SUPERIOR |          |
|             | 6    | TUERCA A             |          |
|             | 7    | TORNILLO<br>M10x75   | 47-80020 |
|             | 8    |                      |          |
|             |      |                      |          |

**ESTRUCTURA : SUSPENSION DELANTERA**

---

| Ref. | Título                    | Código   |
|------|---------------------------|----------|
| 9    | TUERCA A                  |          |
| 10   | PARRILLA INFERIOR         |          |
| 11   |                           |          |
| 12   | TORNILLO M10x40           |          |
| 13   | TUERCA A                  |          |
| 14   | TORNILLO M8x20            | 47-80030 |
| 15   | TUERCA CASTILLO M12       | 47-80105 |
| 16   | ESPINA M2,5x30            | 47-80310 |
| 17   |                           |          |
| 18   | TORNILLO M6x12            | 47-80025 |
| 19   | TORNILLO M6x12            | 47-80025 |
| 20   | CALIPER DE FRENO          | 47-80410 |
| 21   | DISCO DE FRENO            |          |
| 22   | SELLO DE ACEITE PG25x47x7 | 47-80300 |
| 23   |                           |          |
| 24   |                           |          |
| 25   | SELLO DE ACEITE           |          |
| 26   | TORNILLO M10X30           |          |

**ESTRUCTURA : SUSPENSION DELANTERA**

---

| Ref. | Título                           | Código   |  |
|------|----------------------------------|----------|--|
| 27   | MAZA DEL ANTERA                  |          |  |
| 28   | LLANTA D ELANTERA 5.8X8 CHAPA    | 47-80595 |  |
| 28   | LLANTA D ELANTERA 5.8X8 ALUMINIO | 47-80645 |  |
| 29   | TUERCA A                         |          |  |
| 30   |                                  | 47-80485 |  |
| 31   |                                  |          |  |
| 32   | TUERCA CASTILLO M14              |          |  |
| 33   | ESPINA 3X30                      |          |  |
| 34   | TAPA DE RUEDA DE LANTERA         | 47-80440 |  |